

## 35.1 GENERAL INFORMATION

PERFORMANCE RELATED	MATERIAL	INSTALLATION RELATED

### Product

The WERCS AnkaScrew™ Anchor is a medium duty, rotation setting thread forming anchor.

### Benefits, Advantages and Features

#### Fast and easy to install:

- Simply screws into hole.

#### Fast and easy to remove:

- Screws out leaving an empty hole with no protruding metal parts to grind off.

#### Close to edge and for close anchor spacing:

- Does not expand and burst brick and block.

### Installation

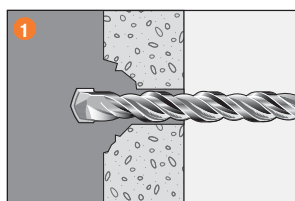

1. Drill hole to correct diameter and depth.

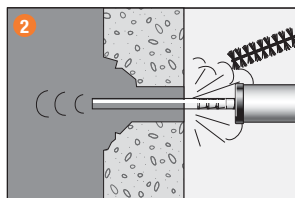

2. Clean thoroughly with brush. Remove debris by way of vacuum or hand pump, compressed air etc.

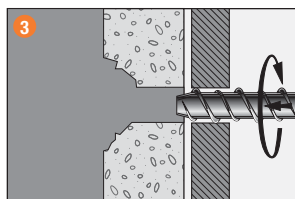

3. Using a socket wrench, screw the AnkaScrew™ into the hole using slight pressure until the self tapping action starts.

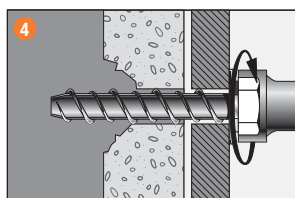

4. Tighten the AnkaScrew™. If resistance is experienced when tightening, unscrew anchor one turn and re-tighten. Ensure not to over tighten.

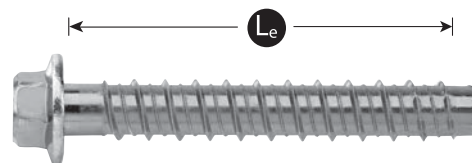

## Principal Applications into Brick and Block

- Wall mounted pipe brackets.
- Gate hinges.

### Installation and Working Load Limit performance details

Anchor size, $d_b$ (mm)	Installation details				Working Load Limit (kN)							
	Drilled hole diameter, $d_h$ (mm)	Fixture hole diameter, $d_f$ (mm)	Anchor effective depth, $h$ (mm)	Tightening torque, $T_t$ (Nm)	Solid Brick		3 Hole Brick		10 Hole Brick		Concrete Block	
					Shear, $V_a$	Tension, $N_a$	Shear, $V_a$	Tension, $N_a$	Shear, $V_a$	Tension, $N_a$	Shear, $V_a$	Tension, $N_a$
5	5	7	25	8	1.5	1.2	1.2	1.0	1.1	0.5	1.2	0.8
6	6	8	30	10	3.2	1.8	3.0	2.4	1.8	0.60	2.1	0.90
8	8	10	40	10	4.0	2.7	3.8	2.7	2.3	0.65	2.1	1.00
10	10	12	50	15	4.4	3.9	4.2	2.8	2.5	0.65	2.1	1.00
12	12	15	60	15	4.4	4.5	4.2	3.0	2.5	0.70	2.1	1.15

### 35.2 DESCRIPTION AND PART NUMBERS

Anchor size, $d_b$	Effective length, $L_e$ (mm)	Part No.	
		Zn Hex Head	Gal Hex Head
5	24	AS05030	-
6	44	AS06050W100	AS06050WGM100
	69	AS06075W100	AS06075WGM100
	94	AS060100W100	AS060100WGM100
8	54	AS08060W100	AS08060WGM100
	69	AS08075W100	AS08075WGM100
	94	AS080100W100	AS080100WGM100
10	54	AS10060W50	AS10060WGM50
	69	AS10075W50	AS10075WGM50
	94	AS10100W50	AS10100WGM50
12	69	AS12075W50	AS12075WGM50
	94	AS12100W50	AS12100WGM50
	144	AS12150W20	AS12150WGM20

Effective depth,  $h$  (mm)

$$h = L_e - t$$

$t$  = total thickness of material(s) being fixed

### 35.3 ENGINEERING PROPERTIES

Anchor size, $d_h$ (mm)	Stress area, $A_s$ (mm <sup>2</sup> )	Yield strength, $f_y$ (MPa)	UTS, $f_u$ (MPa)
6	15.9	640	800
8	42.4	640	800
10	69.4	640	800
12	84.1	640	800