



Description

The RamToggle™ is a one piece, light duty nylon cavity fastener.

Specification

Material	Nylon
Corrosion Protection	-
Head Style	Flush
Fixing Method	Fixture Aligned
Setting Method	Rotation
Anchoring Method	Deformation
Screw Gauges	6-8
Hole Diameters	8mm
Required Screw Lengths	30mm, 35mm, 40mm
Maximum Wall Thickness*	5mm-10mm, 8mm-12mm, 12mm-18mm
Substrates	Plasterboard

Features & Benefits

- The RamToggle™ features a wide wingspan for maximum holding power
- Anti-rotation fins prevent spinning in the hole when installing the screw.
- The low-profile head allows for flush fixing.
- The nylon body is non-conductive.

Related Products

Drill, Drill Bits, Drill Driver, Screw Gun, Screwdriver Bits

Trades & Applications

	Miscellaneous Trades	Plumbing Contractor	Electrical Contractor
Light Hook/Bracket Installation	✓		
Electrical Fitting Installation			✓
Bathroom Accessory Installation		✓	

RamToggle™ - Nylon Cavity Fastener

Part No	Hole Ø (mm)	Screw Gauge	Wall Thickness (mm)	Order Qty
RT10	8	6-8	5-10	100
RT12	8	6-8	8-12	100
RT16	8	6-8	12-18	100

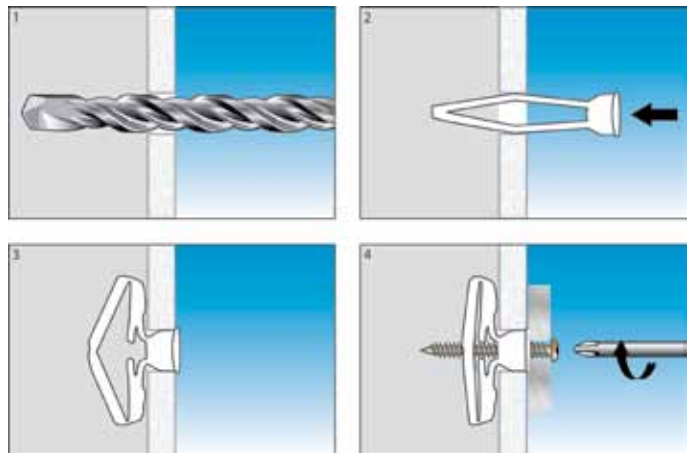

Installation

1. Drill an 8mm hole through the plasterboard.
2. Compress the wings of the RamToggle™ and insert the anchor into the hole. If necessary, tap with a hammer to ensure a flush fit with the surface.
3. The wings will spread behind the cavity wall.
4. Insert the appropriate gauge screw through the fixture, into the RamToggle™ and tighten, pulling the wings of the anchor firm against the cavity wall.