

Description

Ramset™ Spring Toggles are all metal wing cavity anchors, ideal for both wall and ceiling applications.

Specification

Material	Carbon Steel
Corrosion Protection	Zinc Plating
Head Style	Round, Countersunk, Hook
Fixing Method	Screw Through Fixing
Setting Method	Rotation
Anchoring Method	Deformation
Screw Gauges	1/8", 3/16"
Drilled Hole Diameters	7/16", 9/16"
Anchor Lengths	50mm, 75mm, 100mm
Maximum Fixture + Wall Thickness'	15mm, 40mm, 65mm
Substrates	Plasterboard

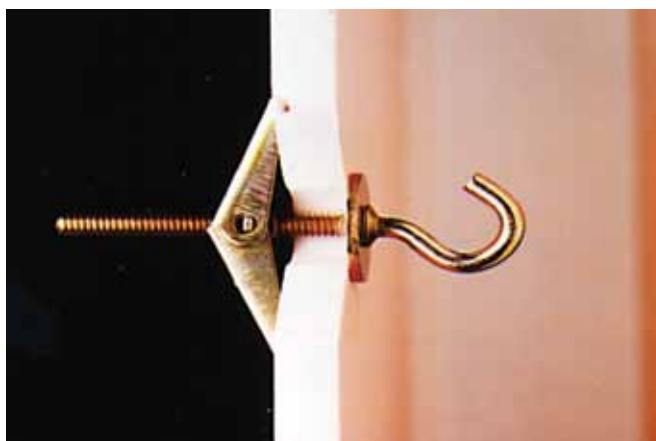

Features & Benefits

- Ramset™ Spring Toggles have a wide wingspan to give high loadings in both plasterboard wall and ceiling applications.
- No protruding flanges allow for flush fixing (Round head only).
- Low profile round or countersunk screw heads suit various fixture recesses. Handy hook profile also available.

Related Products

Drill
Drill Bits
Drill Driver

Screw Gun
Screwdriver Bits

Trades & Applications

	Miscellaneous Trades	Plumbing Contractor	Electrical Contractor
Light Hook/Bracket Installation	✓		
Electrical Fitting Installation			✓
Bathroom Accessory Installation		✓	

Installation

1. Drill the recommended sized hole through the plasterboard.
2. Pass the screw through the fixture and into the toggle for a few turns. Compress the toggle wings and insert the anchor into the hole. The wings will spread behind the cavity wall.
3. Pull back on the fixture to hold the toggle in place against the reverse side of the cavity wall and tighten with a screwdriver, pulling the wings of the anchor firm against the cavity wall.

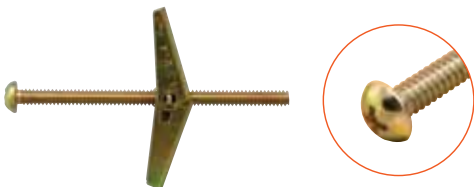
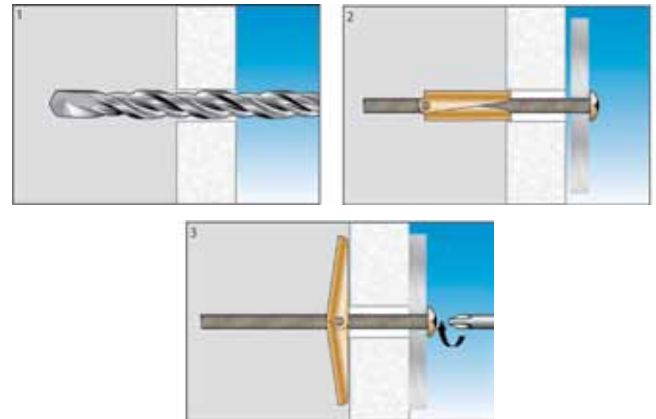

Spring Toggle - Cavity Fastener - Round Head - Zinc Plated

Part No	Screw Gauge	Max Fixture + Wall Thickness (mm)	Screw Length (mm)	Drilled Hole Ø (mm)	Order Qty
STR04050	1/8"	15	50	7/16"	100
STR05050	3/16"	15	50	9/16"	100
STR05075	3/16"	40	75	9/16"	50
STR05100	3/16"	65	100	9/16"	50

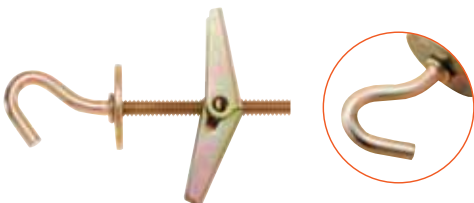

Spring Toggle - Cavity Fastener - Hook - Zinc Plated

Part No	Screw Gauge	Max Wall Thickness (mm)	Screw Length (mm)	Drilled Hole Ø (mm)	Order Qty
STK05050	3/16"	15	50	9/16"	50