

Description

The ToggleMate™ is a self drilling toggle anchor for heavy duty, vibration resistant fixing in plasterboard.

Specification

Material	Zinc Composite
Corrosion Protection	-
Head Style (Anchor)	Flush - Phillips #2
Head Style (Screw)	Pan - Phillips #2
Fixing Method	Fixture Aligned
Setting Method	Rotation
Anchoring Method	Deformation
Screw Gauges	8
Anchor Length	64mm
Screw Length	55mm
Substrates	Plasterboard



Features & Benefits

- The ToggleMate™ features an effective drill point for easy penetration of plasterboard and fast installation.
- The anchor's screw thread profile is designed for efficient cutting and positive grip, while the movable toggle allows the anchor to clamp the plasterboard for added strength.
- Both the screw and the ToggleMate™ can be easily removed without losing the anchor inside the cavity.
- The low profile head allows for flush fixing.

Related Products

- Drill Driver
- Screw Gun
- Screwdriver Bits

Trades & Applications

	Miscellaneous Trades	Plumbing Contractor	Electrical Contractor
Light Hook/Bracket Installation	✓		
Electrical Fitting Installation			✓
Bathroom Accessory Installation		✓	

Installation

1. Insert the point of a #2 Philips Head screwdriver into the recess of the ToggleMate™, place the drill point against the wall, lightly piercing the face paper, and screw the anchor into the plasterboard until the head is flush with the surface.
2. Place the fixture over the anchor, insert the 8 gauge screw through the fixture, into the head of the ToggleMate™ and turn to engage the clamp. Continue to turn the screw until the clamp is pulled tight against the plasterboard.

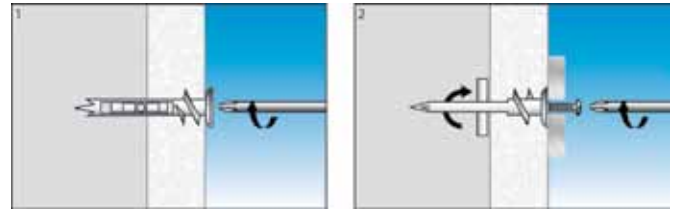

ToggleMate™ - Plasterboard Anchor

Part No	Anchor Length (mm)	Screw Length (mm)	Screw Gauge	Body Type	Order Qty
TM16	64	55	8	Metal	50